

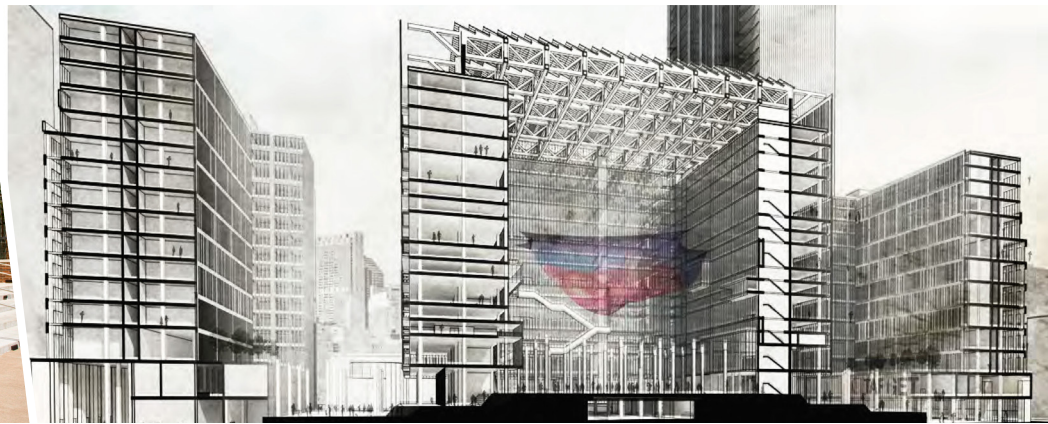

COLLEGE OF
**ENGINEERING, ARCHITECTURE
AND TECHNOLOGY**

ARCH ARCHITECTURE



WHAT IS ARCHITECTURE?

Architecture is a profession that combines art and science in near equal measures; the technical demands of a work of architecture are equally as important as the way in which the building responds to human needs and the context and culture to which it will ultimately contribute. For this reason, students of architecture must be ready and willing to commit to the math and science demanded of the required technical studies, while at the same time being appreciative of the artistic endeavor.

WHY ARCHITECTURE AT OSU?

Dedicated faculty, state-of-the-art facilities in the Donald W Reynolds School of Architecture Building, and a community of like-minded students combine to create a learning environment that has been recognized by Design Intelligence as one of the "Most Admired" schools of architecture in the USA. Students are challenged through the studio based approach to design education; many times those challenges come in the form of design competitions at the regional or national level. Student success in these design competitions is further evidence of the quality of education offered by the OSU School of Architecture.

HIGHLIGHTS

- The five-year NAAB-accredited Bachelor of Architecture degree is the most economical route available for students wishing to enter the professional practice of architecture and become a licensed architect.
- The program's curriculum provides students with a well-rounded studio-based education accompanied by supporting core areas of emphasis in technology, architectural history and theory, and architectural management. Computers and digital applications are integrated throughout the design experience of the program.
- The record of OSU students' achievements in the design studio is evidenced by their successes in regional, national and international architectural design competitions.
- A one month study abroad experience is required for all Architecture majors; the school offers programs led by OSU faculty in Europe and Asia.
- A twelve credit hour Graduate Certificate is available, focused upon the Integrative Design of the Building Envelope, which concerns a specific technical aspect of building design of interest to the student.

FOCUS AREAS

MINORS AVAILABLE

- Architectural Studies, History and Theory of Architecture
- Architectural Studies, Entrepreneurship and Architecture

CAREER OPPORTUNITIES

- Architect in Professional Practice
- Project Manager
- Designer



ceat.okstate.edu



COLLEGE OF
**ENGINEERING, ARCHITECTURE
AND TECHNOLOGY**

Typical Five-Year Curriculum

FIRST YEAR

Fall Semester

ARCH	1112	Intro to Arch
MATH	2144	Calc I
ENGL	1113	Fresh Comp I
POLS	1113	American Govt
XXXX	XXXX	"S" Elective

Spring Semester

ARCH	1216	Arch Design I
PHYS	1114	Gen Physics
ARCH	2003	Arch & Society
ENGL	1213	Comp II

SECOND YEAR

Fall Semester

ARCH	2116	Arch Design II
ENSC	2113	Statics
ARCH	2203	Arch & Society II
ARCH	3252	Computers I
XXXX	XXXX	Natural Sciences Elective

Spring Semester

ARCH	2216	Arch Design III
ARCH	2263	Arch Systems
HIST	1103	American Hist
XXXX	XXXX	"D" Elective

THIRD YEAR

Fall Semester

ARCH	3116	Arch Design IV
ARCH	3263	Arch Materials
ARCH	3323	Steel I
ARCH	XXXX	ARCH "H" Elective
XXXX	XXXX	"S" Elective

Spring Semester

ARCH	3216	Arch Design V
ARCH	3134	Arch Science I
ARCH	3223	Timbers
ARCH	3262	Computer II
ARCH	XXXX	ARCH Elective

Summer Semester

ARCH	4374	International Experience
ARCH	XXXX	ARCH Elective

FOURTH YEAR

Fall Semester

ARCH	4116	Arch Design VI
ARCH	3433	Arch Science II
ARCH	4123	Concrete I
XXXX	XXXX	Controlled Elective

Spring Semester

ARCH	4216	Arch Design VII
ARCH	4263	Seminar
ARCH	4093	Proj Mgmt
XXXX	XXXX	Controlled Elective

FIFTH YEAR

Fall Semester

ARCH	5117	Arch Design VIII
ARCH	5193	Arch Mgmt
ARCH	XXXX	ARCH Elective
XXXX	XXXX	Controlled Elective
XXXX	XXXX	Controlled Elective

TOTAL HOURS: 154

In the United States, most registration boards require a degree from an accredited professional degree program as a prerequisite for licensure. The National Architectural Accrediting Board (NAAB), which is the sole agency authorized to accredit professional degree programs in architecture offered by institutions with U.S. regional accreditation, recognizes three types of degrees: the Bachelor of Architecture, the Master of Architecture, and the Doctor of Architecture. A program may be granted an eight-year, three-year, or two-year term of accreditation, depending on the extent of its conformance with established educational standards. Doctor of Architecture and Master of Architecture degree programs may require a preprofessional undergraduate degree in architecture for admission. However, the preprofessional degree is not, by itself, recognized as an accredited degree.

The Oklahoma State University School of Architecture offers the following NAAB-accredited degree programs:
B. Arch. (154 undergraduate credits)

Next accreditation visit: 2025



COLLEGE OF
**ENGINEERING, ARCHITECTURE
AND TECHNOLOGY**

This course plan is for general guidance only. An official course plan will be provided upon enrollment.

Contact | ceat.recruitment@okstate.edu | (405)-744-5279